



STAPLETON DERBY



231 Speakman Road

Dentons Green, St. Helens, WA10 6TH

£149,950



NO UPWARD CHAIN INVOLVED Stapleton Derby are delighted to offer for sale this two bedroom mid terrace property situated in the sought after Dentons Green area. Being close to well regarded schools and local amenities making this an ideal home for a first time buyer or family. Benefitting from a gas central heating system and double glazing the accommodation briefly comprises of entrance hall, spacious lounge, dining room, fitted kitchen. First floor landing serving two bedrooms plus bathroom. Externally there are gardens to the front and rear. Viewing is strongly advised to appreciate this lovely home.



Floor Plans

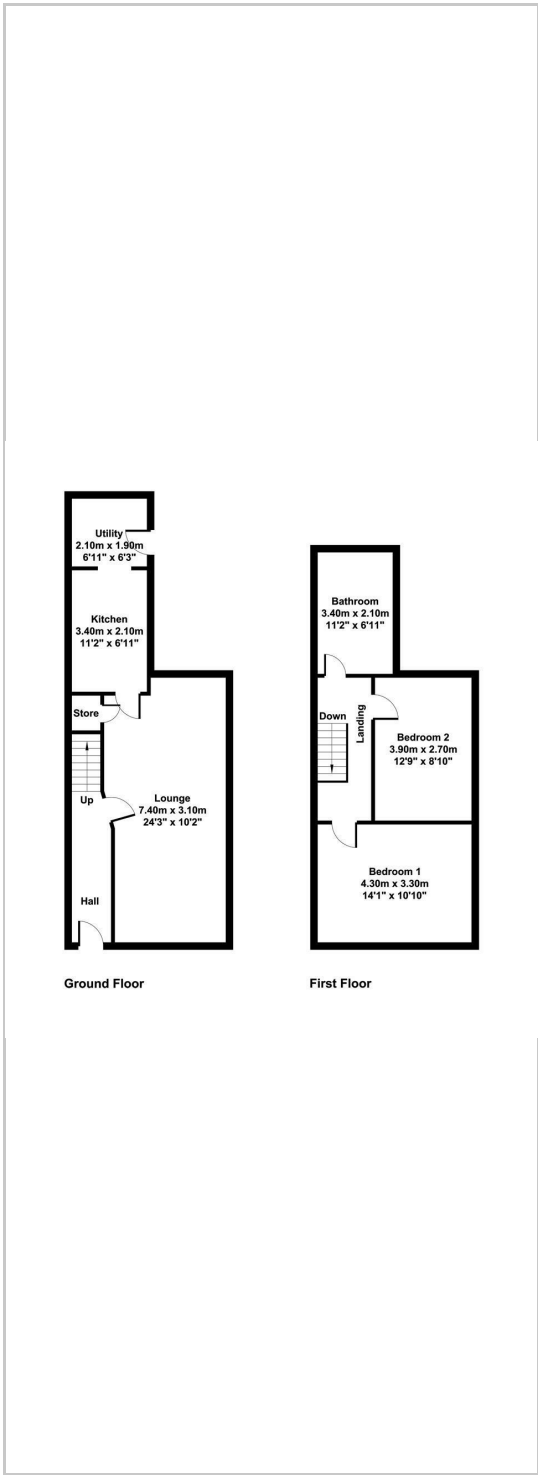

Energy Efficiency Graph

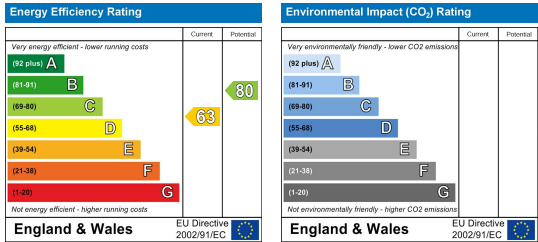

IMPORTANT NOTICE TO PURCHASERS

We endeavor to make our sales particulars accurate and reliable, however, they do not constitute or form part of an offer or any contract and none is to be relied upon as statements of representation or fact. Any services, systems and appliances listed in this specification have not been tested by us and no guarantee as to their operating ability or efficiency is given. All measurements have been taken as a guide to prospective buyers only, and are not precise. If you require clarification or further information on any points please contact us. Fixtures and fittings other than those mentioned are to be agreed with the seller.